

# TOYOTA HILUX

**1/12 SCALE OFF-ROAD ELECTRIC 4WD VEHICLE**  
**1/12 電動越野四驅車**



The contents are subject to change without prior notice due to product improvements and specification changes.  
本套件所附之零件可能跟圖示有所差異。因產品後續之設計研發或功能不斷改善之因，我們將保留產品規格變更權利，不再另行通知使用者。

Thunder Tiger offers online help on [thundertiger.com](http://thundertiger.com), our product specialists are ready to take your call if you have any technical questions. Have fun and enjoy the exciting world of R/C.

若您在產品的使用上有任何的疑問，歡迎多加利用我們所提供的即時諮詢留言版或洽詢雷虎科技授權經銷商。雷虎科技的全球英文網址為 [thundertiger.com](http://thundertiger.com)，我們將竭誠為您服務！

## Maintenance Manual & Parts Catalogue 維修說明書及零件包型錄

### WARRANTY 品質保證事項

Thunder Tiger Corporation guarantees this model is free from defects in both material and workmanship. The total monetary value under warranty will in no case exceed the cost of the original product purchased. This warranty does not cover any components damaged by use or modification. Part or parts missing from this product must be reported within 60 days of purchase. No part or parts will be sent under warranty without proof of purchase. To receive part or parts under warranty, the service center must receive a proof of purchase and/or the defective part or parts. Should you find a defective or missing part, contact the authorized Thunder Tiger Service/Distributor near you. Under no circumstances a dealer or distributor accept return the product has been used.

本公司對於製造過程中產生之瑕疵，負完全品質保證責任。保證事項僅限於產品本身與隨產品所附之零配件。品質保證不包含因使用、組裝或調整本產品或其他所有非產品本身品質所造成之損壞。

# Safety Precautions 安全注意事項

Please read all of the instructions and familiarize yourself with the product and its controls before operation.

1. This product is not a toy. It is a high performance model car therefore it is important to familiarize yourself with the model, its manual, and its construction before assembly or operation. Adult supervision is necessary for children operating this model.
2. Always keep this instruction manual on hand during assembly and for operating reference.
3. Do not use a power screwdriver to install screws into plastic parts. A power screwdriver's high rotation speed can heat up the screw being installed which can result in some melting of the plastic parts or stripped threads.
4. For best performance, it is important to make sure all the moving parts can move freely without binding.
5. This product, its parts, and its assembly tools can be harmful to your health. Always exercise extreme caution when assembling and operating this product. Keep away from any high speed rotating parts during operation.

感謝您購買雷虎科技產品，在您開始操作本產品前，請詳閱本產品說明書。

1. 本產品為高性能模型產品非一般玩具，組裝與操作過程皆須由成人陪同。請詳讀此本使用說明書，避免因組裝錯誤與操作不當造成損壞。
2. 請妥善保管此說明書，對於後續維修、操控說明將可提供您協助。
3. 請勿使用電動工具旋緊自攻螺絲於塑膠零件上，可能導致塑膠零件融化或滑牙。
4. 請檢視所有活動部位零件是否不受干涉，可靈活作動，以達車輛最佳性能。
5. 此項產品具有相當之危險性，於組裝、調整、操控上的不熟悉都可能造成自身或他人的傷害，發生這些傷害事件時，製造商是可以免除責任的，建議您於初次使用本產品前，先行請教具有相程度經驗同好或是專業雷虎經銷商與模型專賣店。

## Index 索引

STEP1 Chassis 車體	P.2	STEP12 Center Drive Shaft 中央傳動軸	P. 9
STEP2 Front/Rear Differential 前/後差速組	P.3	STEP13 Front Bumper 前防撞板	P. 9
STEP3 Front Axle 前傳動組	P.4	STEP14 Rear Bumper 後防撞板	P.10
STEP4 Front Steering Set 前轉向組	P.4	STEP15 Side Guard 側板	P.10
STEP5 Rear Hub Set 後輪座組	P.5	STEP16 Battery Plate 電池板	P.11
STEP6 Shock Assembly 避震器組	P.5	STEP17 Servo Set 伺服機組	P.11
STEP7 Steering Turnbuckle 轉向拉杆	P.6	STEP18 Steering Turnbuckle 轉向拉杆	P.12
STEP8 Front Suspension 前懸吊組	P.6	STEP19 Front/Rear Body Post 前/後車殼支柱	P.12
STEP9 Rear Suspension 後懸吊組	P.7	STEP20 Tires&Wheels 輪胎與輪框	P.13
STEP10 Center Gear Case 中央齒輪箱	P.8	STEP21 LED Light Bar Set 車殼燈架組	P.13
STEP11 Motor 馬達組	P.8	STEP22 Body 車殼	P.14

## Tools Required For Assembly 組裝維修工具

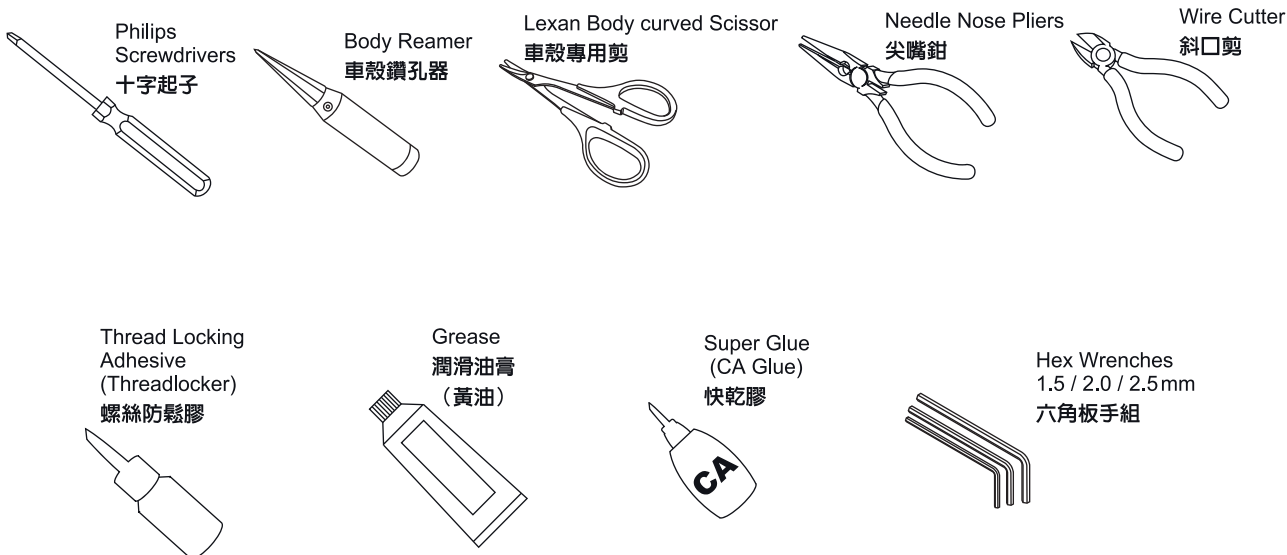

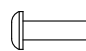

# STEP1 Chassis 車體

-  2.5x8mm SRH Screw  
半圓頭內六角螺絲
-  2.5x10mm SRH Screw  
半圓頭內六角螺絲
-  2.5x10mm SFH Screw  
平頭內六角螺絲

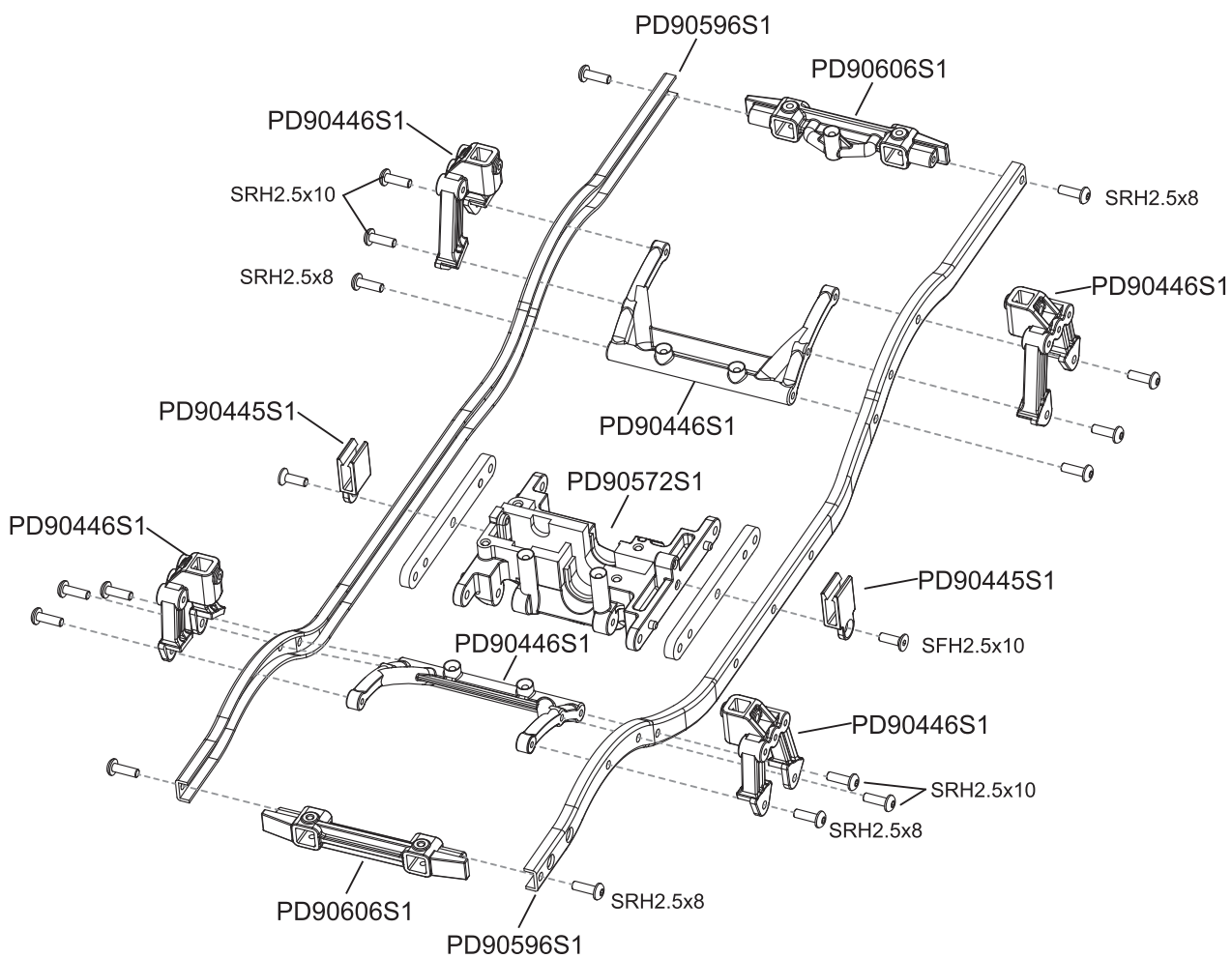

## STEP2

## Front/Rear Differential 前/後差速組

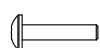

2x10mm SRH Screw  
半圓頭內六角螺絲

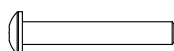

3x20mm SRH Screw  
半圓頭內六角螺絲 有牙



3x6mm SFH Screw  
平頭內六角螺絲



5x10x4mm Bearing  
培林

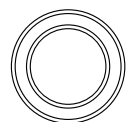

10x15x4mm Bearing  
培林

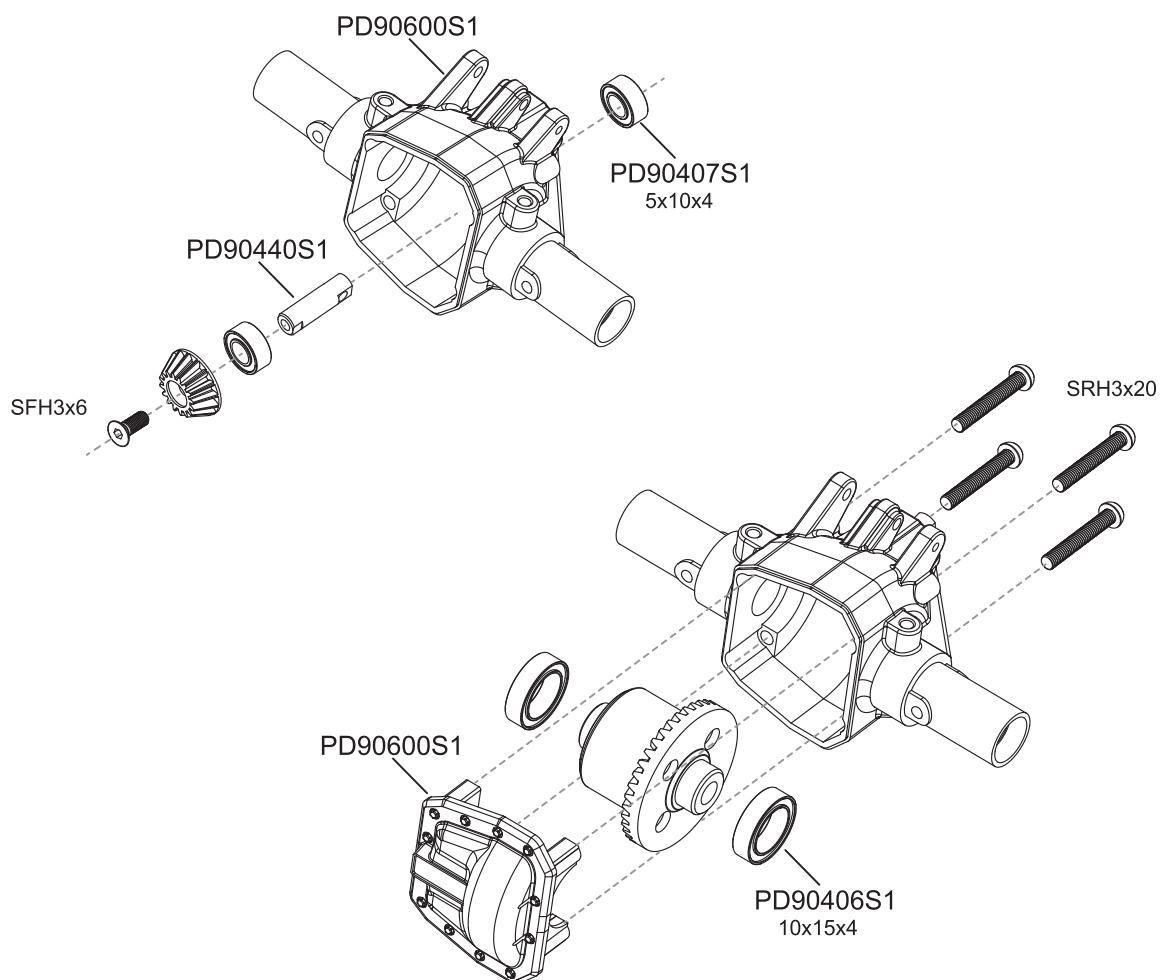
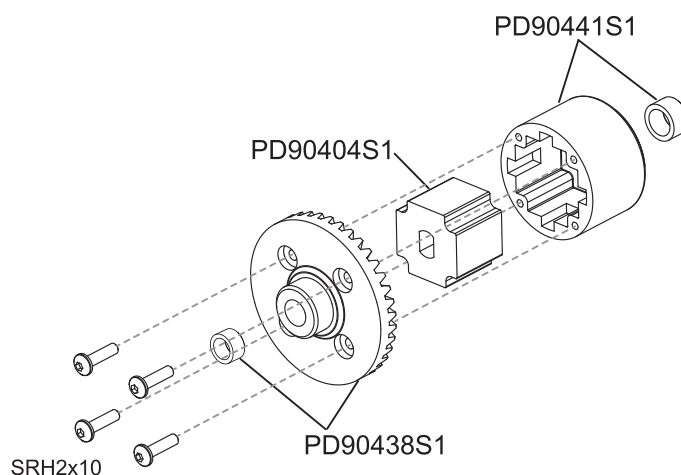



### STEP3 Front Axle 前傳動組



3x4mm SRH Screw  
半圓頭內六角螺絲

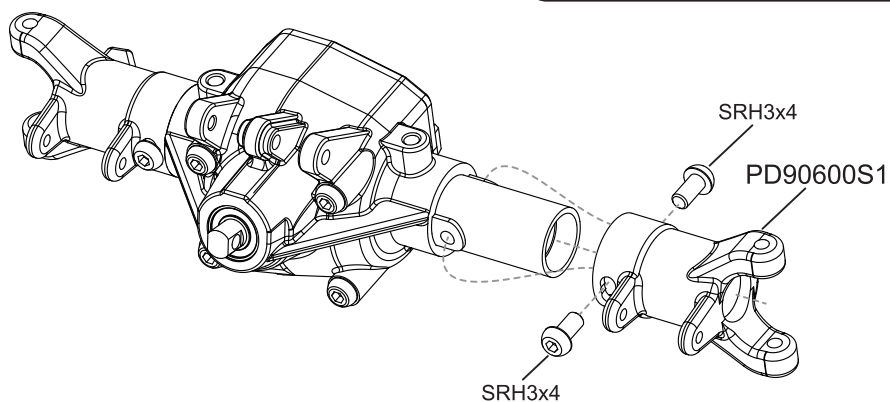
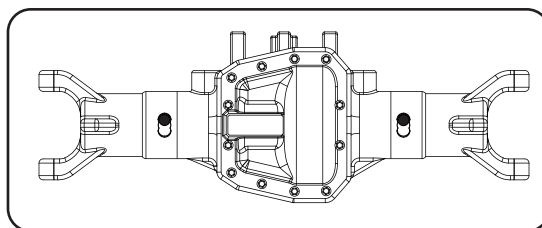

### STEP4 Front Steering Set 前轉向組



2x10.8mm Pin  
銷



5x10x4mm Bearing  
培林

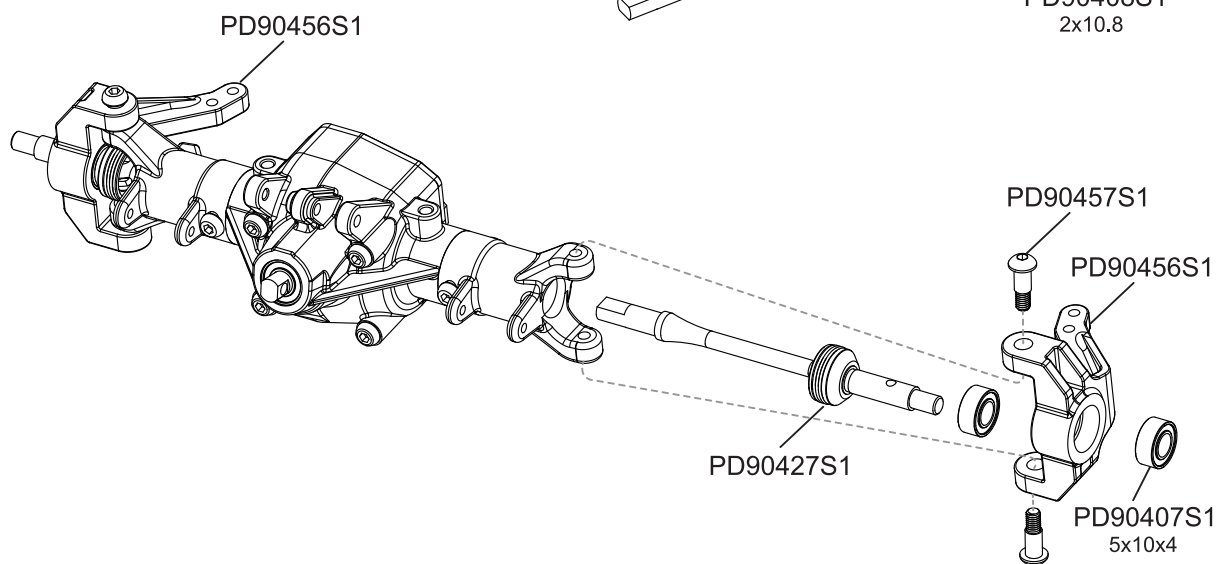
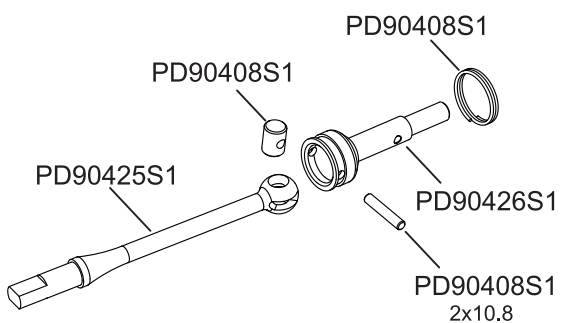

## STEP5

## Rear Hub Set 後輪座組



3x4mm SRH Screw  
半圓頭內六角螺絲



5x10x4mm Bearing  
培林

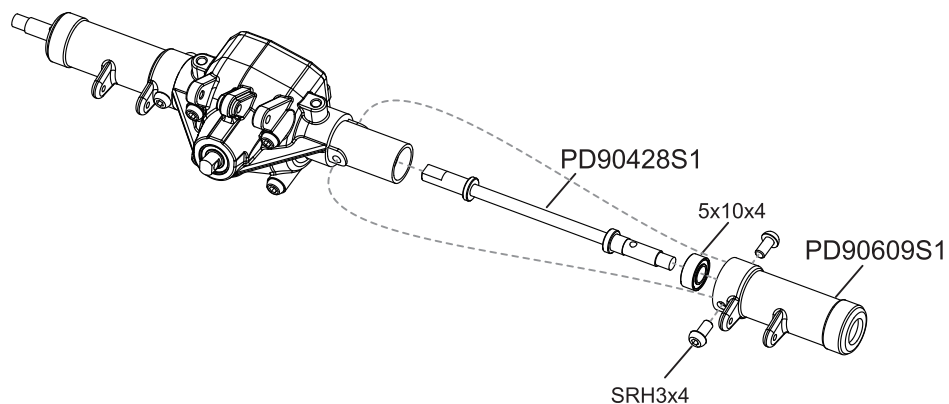

## STEP6

## Shock Assembly 避震器組

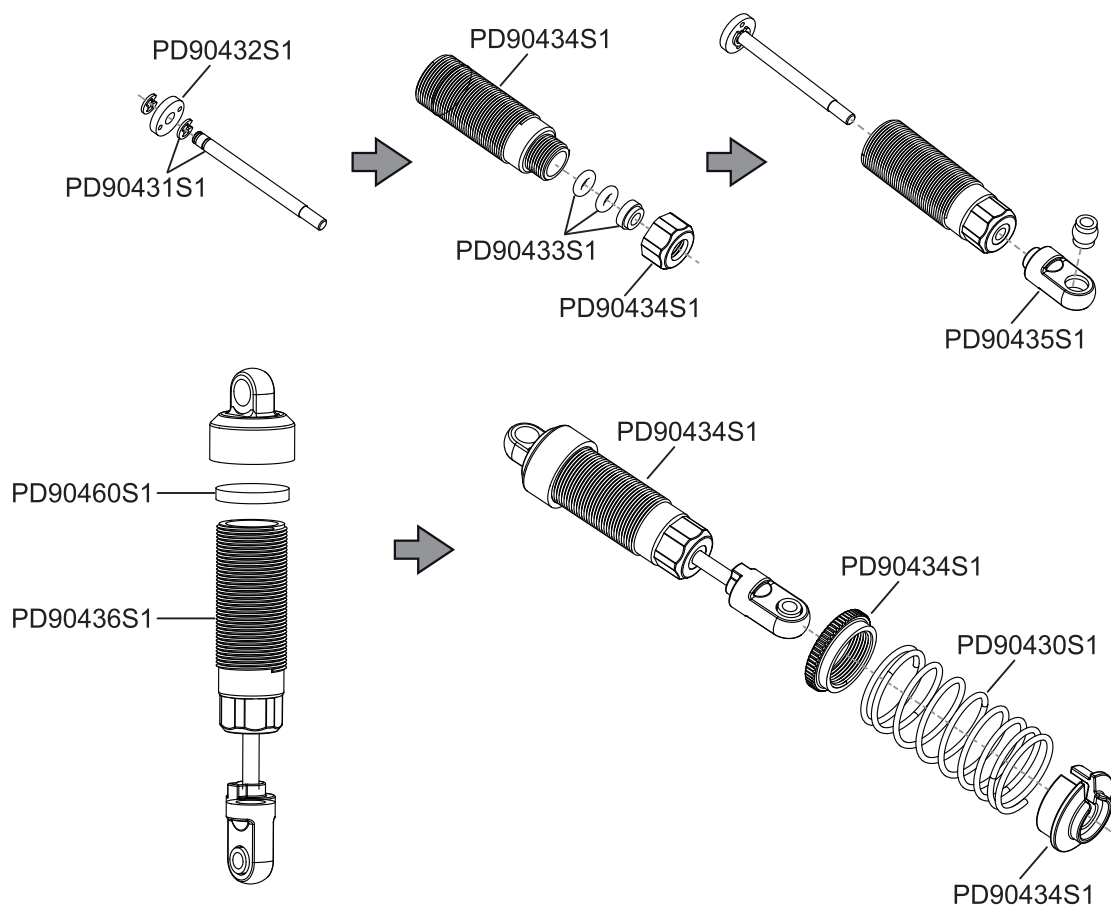



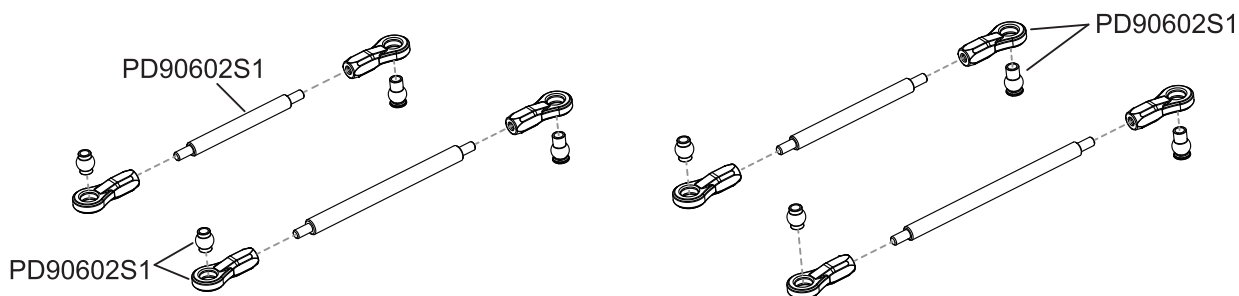

## STEP7 Steering Turnbuckle 轉向拉杆

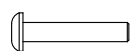

## STEP8 Front Suspension 前懸吊組

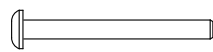
-  2.5x14mm SRH Screw  
半圓頭內六角螺絲
-  2.5x18mm SRH Screw  
半圓頭內六角螺絲
-  2.5x25mm SRH Screw  
半圓頭內六角螺絲

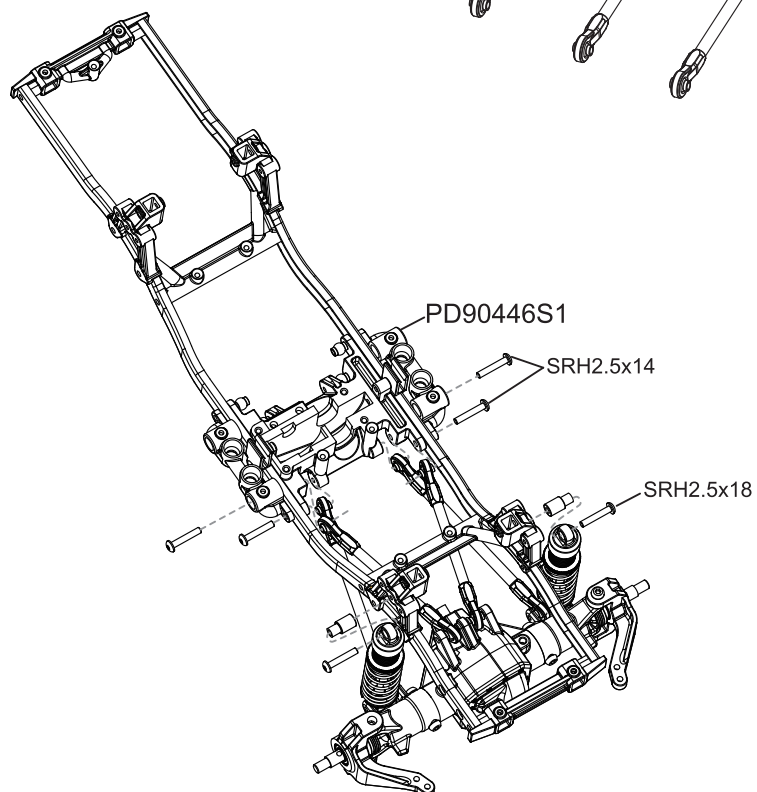
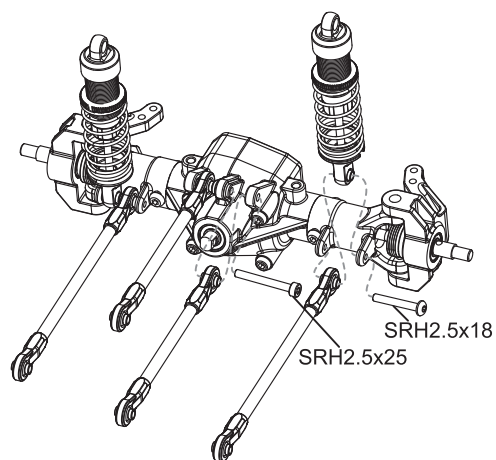

## STEP9

## Rear Suspension 後懸吊組

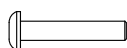

2.5x14mm SRH Screw  
半圓頭內六角螺絲

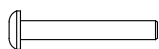

2.5x18mm SRH Screw  
半圓頭內六角螺絲

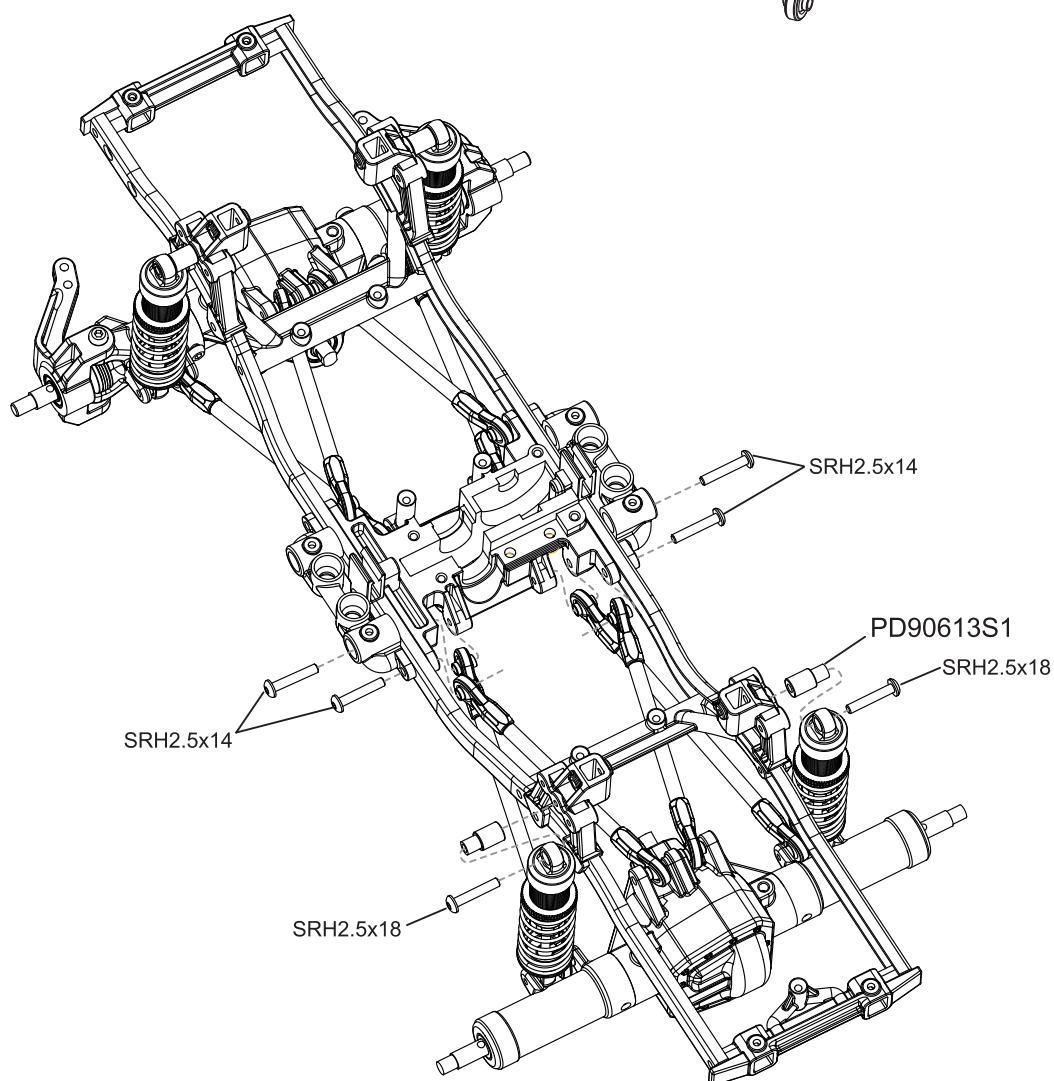
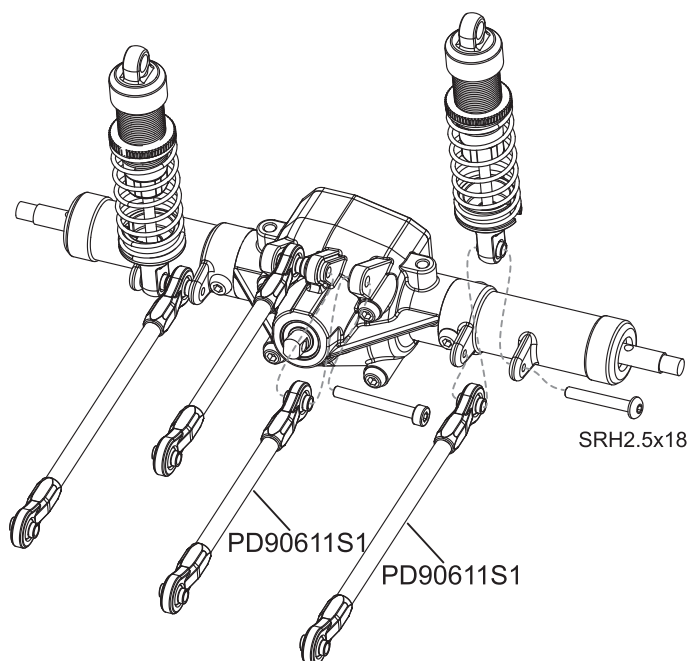



## STEP10 Center Gear Case 中央齒輪箱



3x8mm SRH Screw  
半圓頭內六角螺絲



2x7.8mm Pin  
銷

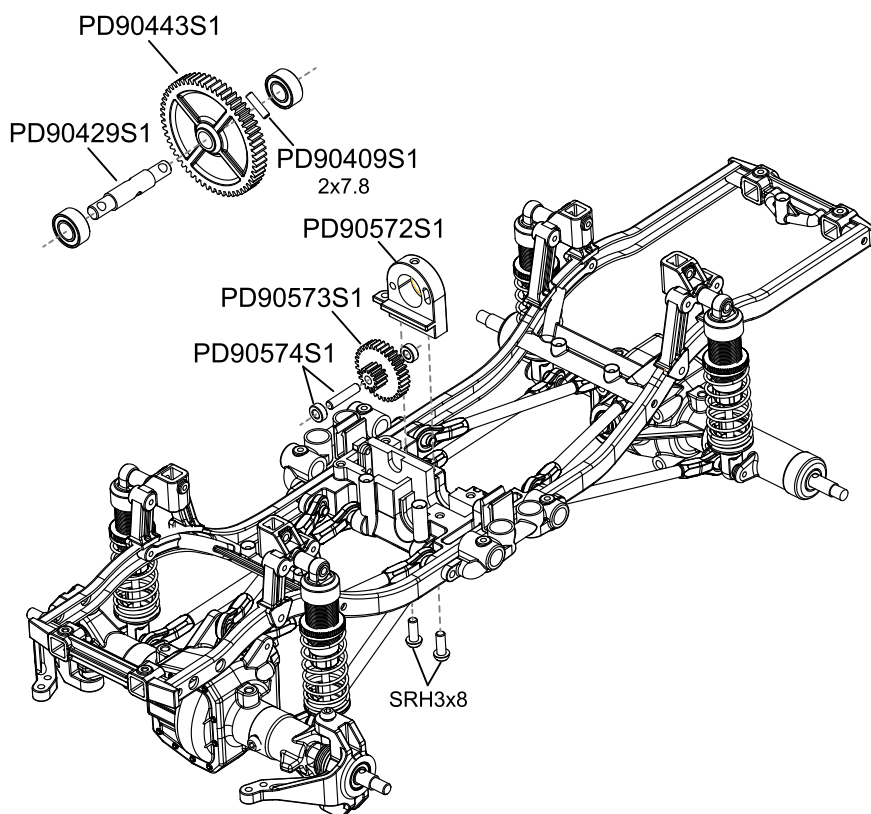

## STEP11 Motor 馬達組

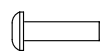

2.5x10mm SRH Screw  
半圓頭內六角螺絲

PD90583S1

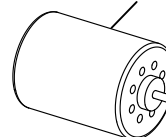

PD90444S1

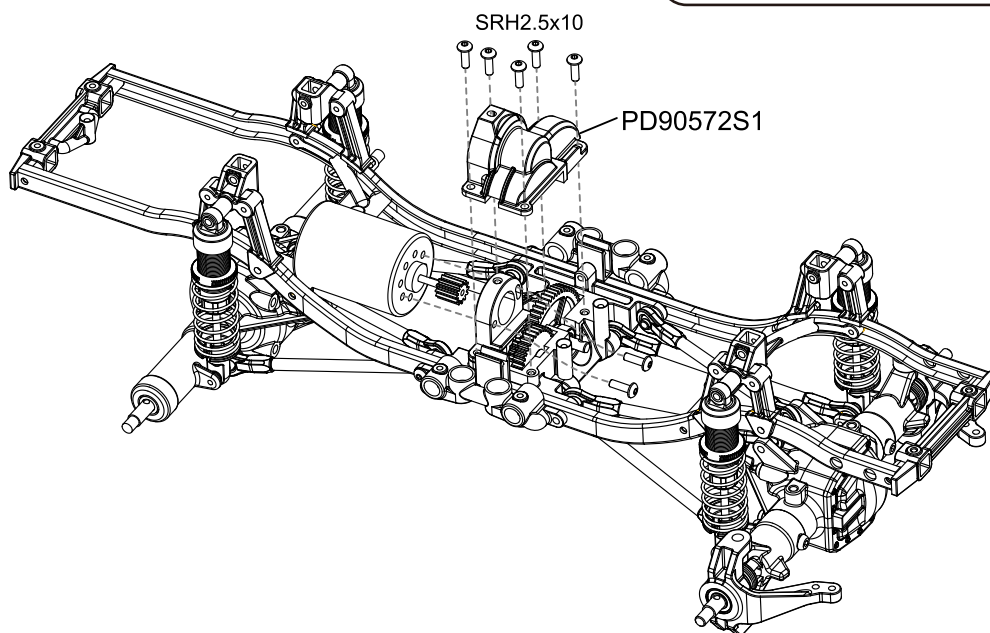

## STEP12 Center Drive Shaft 中央傳動軸

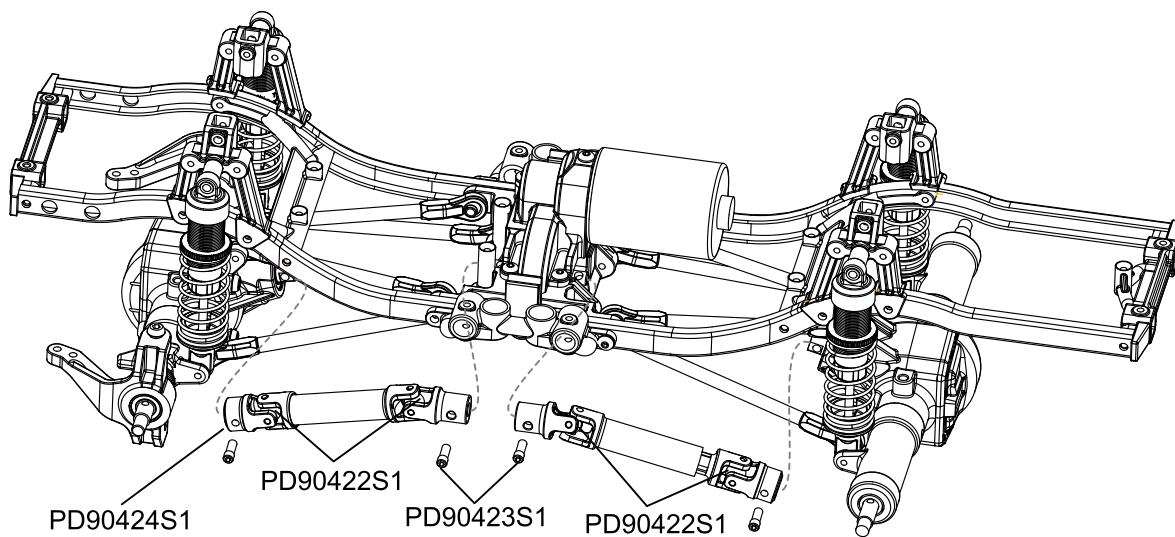

## STEP13 Front Bumper 前防撞板



2x8mm SBH Screw  
有合內六角螺絲



2.5x10mm SRH Screw  
半圓頭內六角螺絲

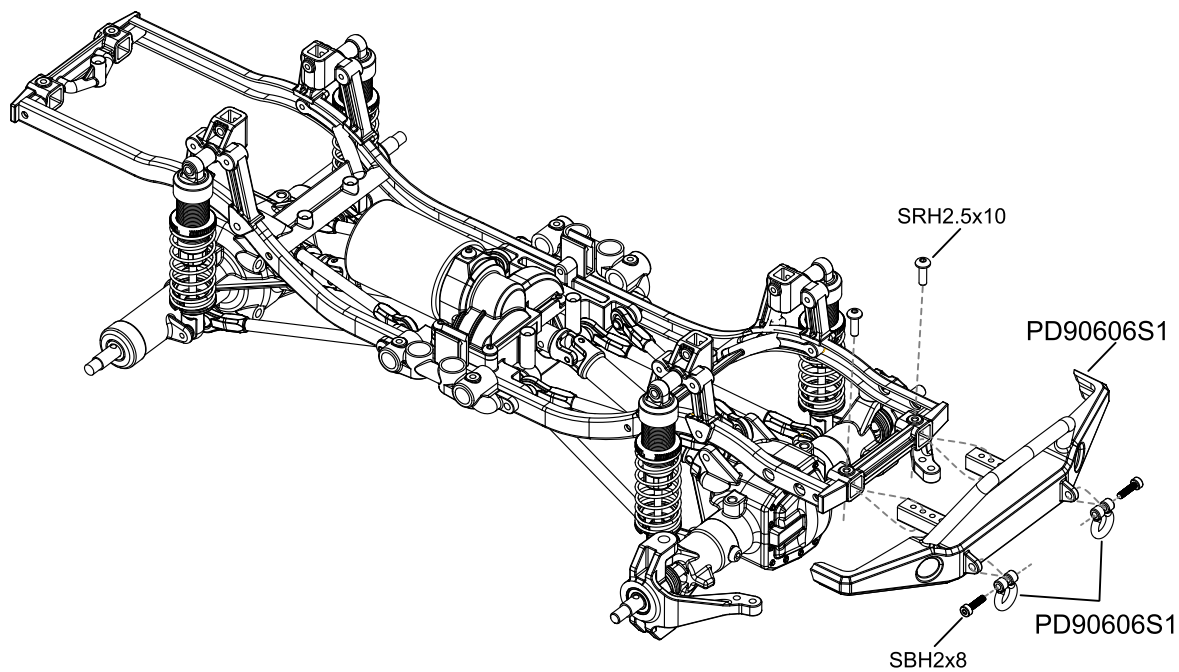



## STEP14 Rear Bumper 後防撞板

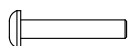
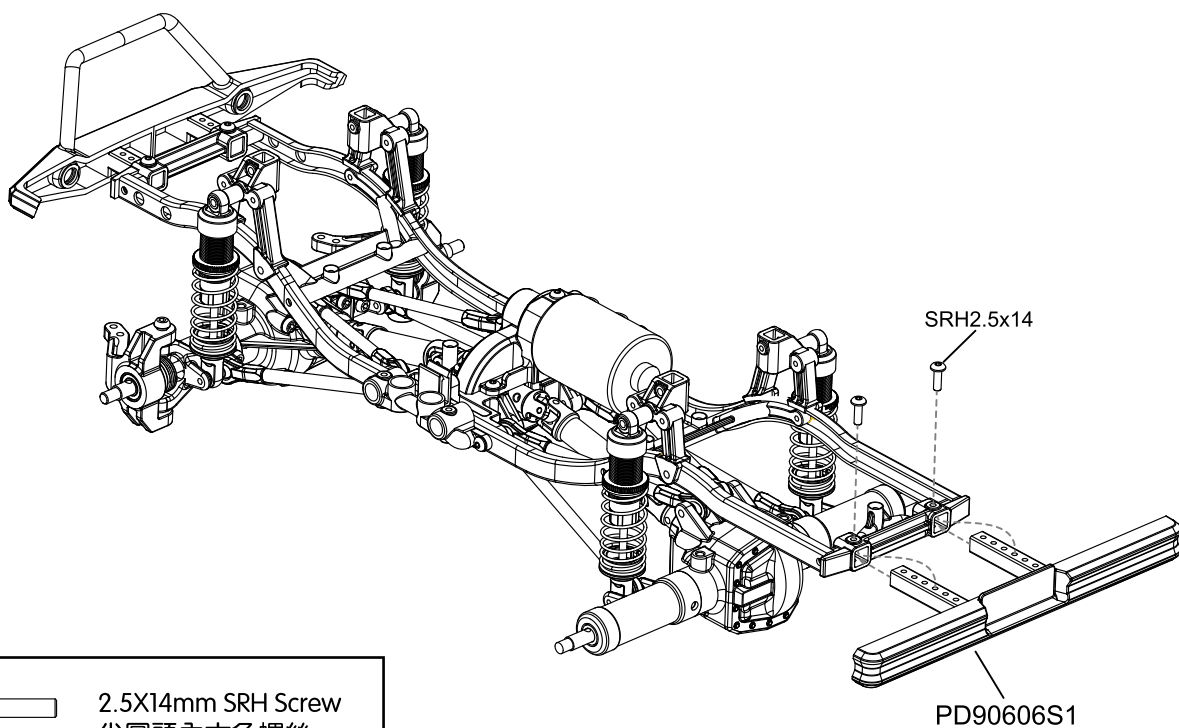

2.5X14mm SRH Screw  
半圓頭內六角螺絲

## STEP15 Side Guard 側板

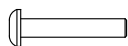
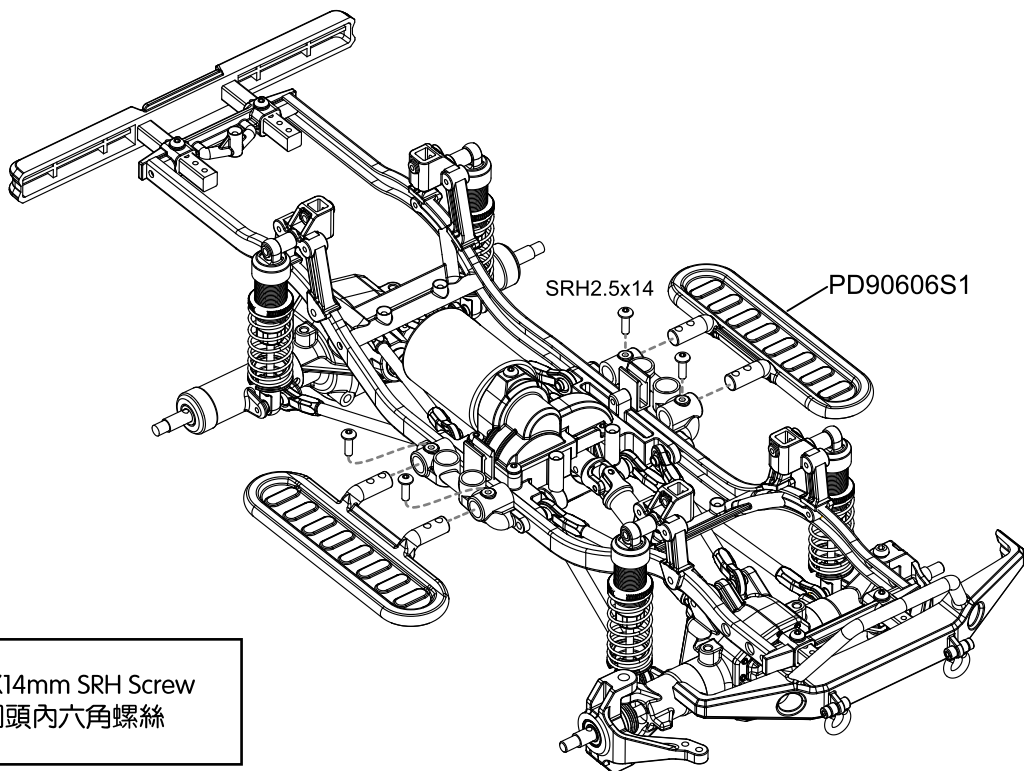

2.5X14mm SRH Screw  
半圓頭內六角螺絲

## STEP16 Battery Plate 電池板

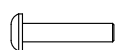
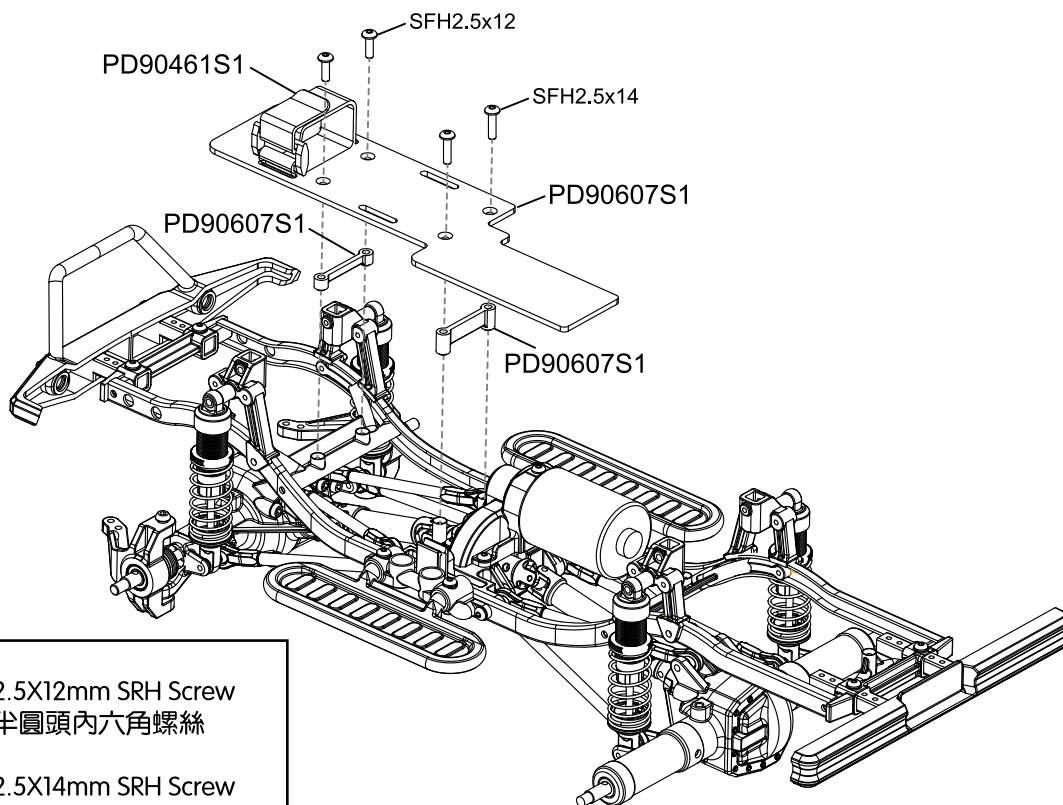

2.5X12mm SRH Screw  
半圓頭內六角螺絲

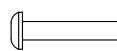

2.5X14mm SRH Screw  
半圓頭內六角螺絲

## STEP17 Servo Set 伺服機組

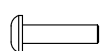

2.5X10mm SRH Screw  
半圓頭內六角螺絲

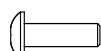

3X10mm SRH Screw  
半圓頭內六角螺絲

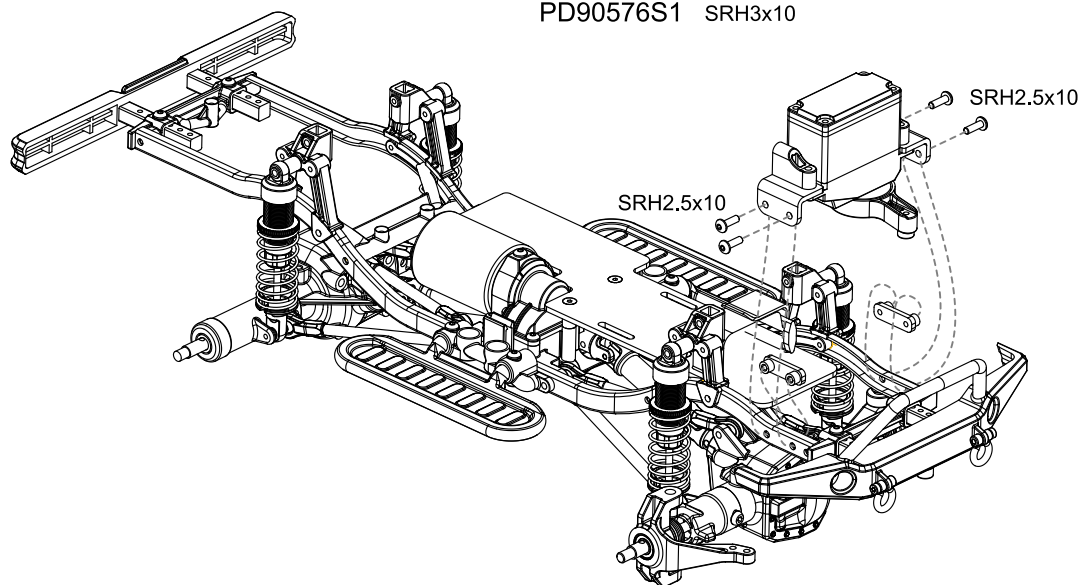
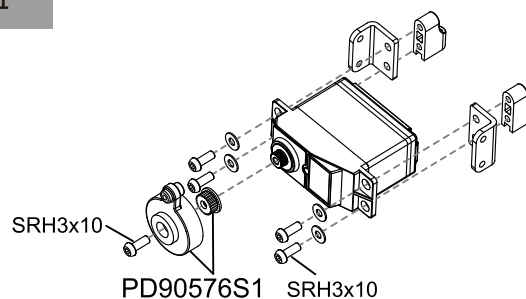

## STEP18 Steering Turnbuckle 轉向拉杆

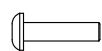

2.5X10mm SRH Screw  
半圓頭內六角螺絲

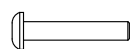

2.5X14mm SRH Screw  
半圓頭內六角螺絲

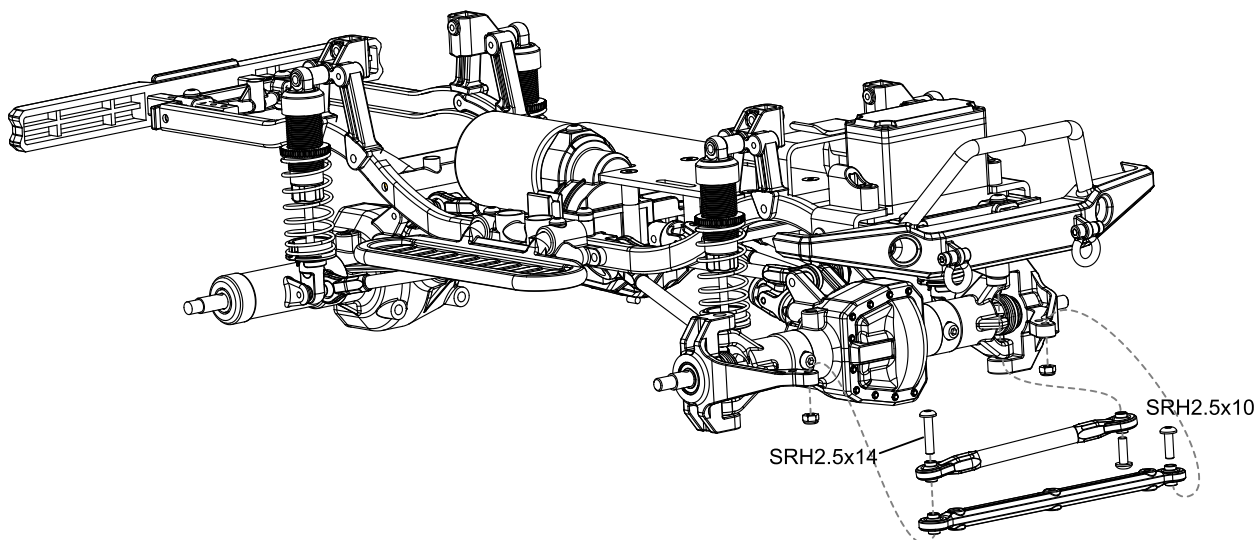
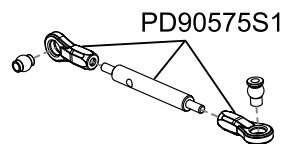

## STEP19 Front/Rear Body Post 前/后車殼支柱

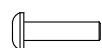

2.5X10mm SRH Screw  
半圓頭內六角螺絲

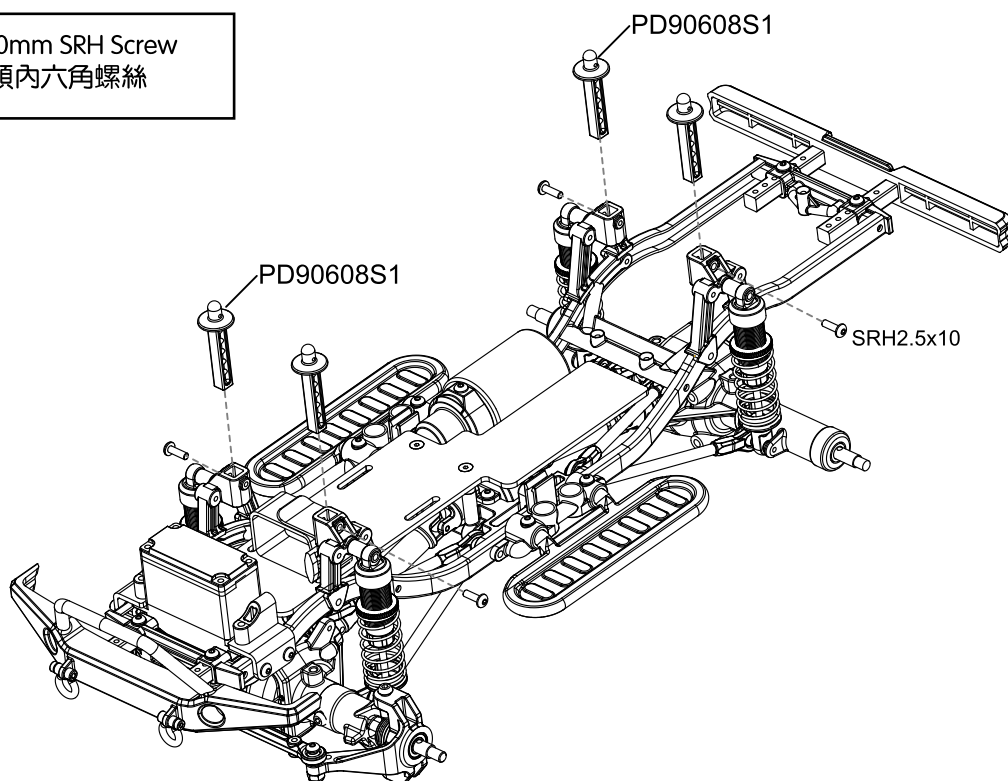

## STEP20 Tires&Wheels 輪胎與輪框

2x9.8mm Pin  
銷

M4 Lock Nut  
防鬆螺帽

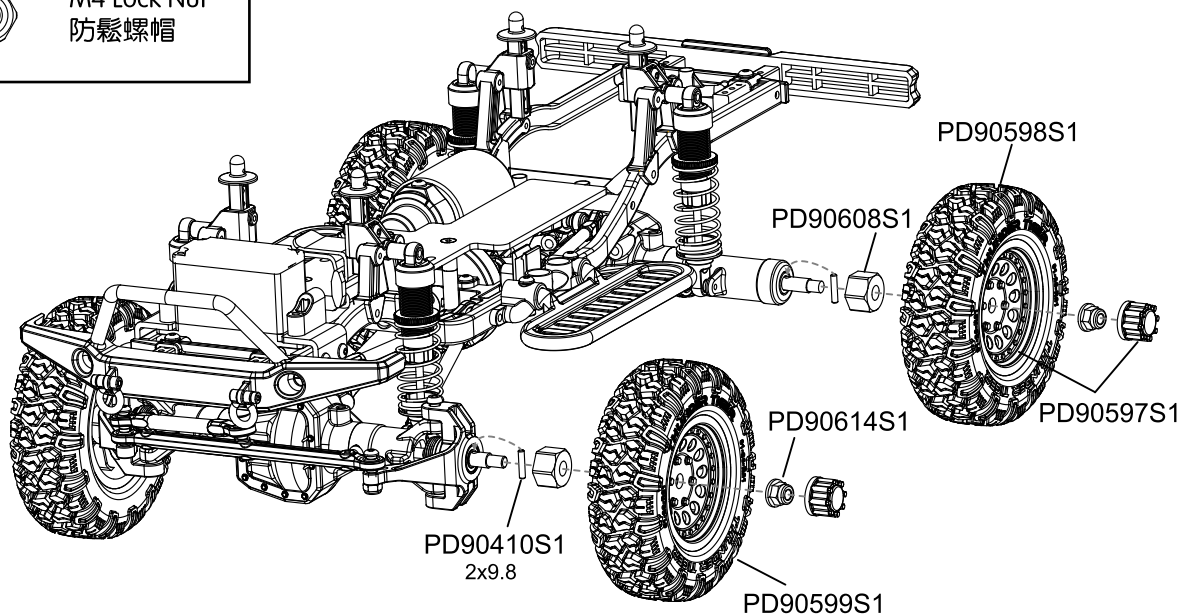

## STEP21 LED Light Bar Set 車殼燈架組

2x4mm SBH Screw  
有合內六角螺絲

2.5x6mm SRH Screw  
半圓頭內六角螺絲

2.5X8mm SRH Screw  
半圓頭內六角螺絲

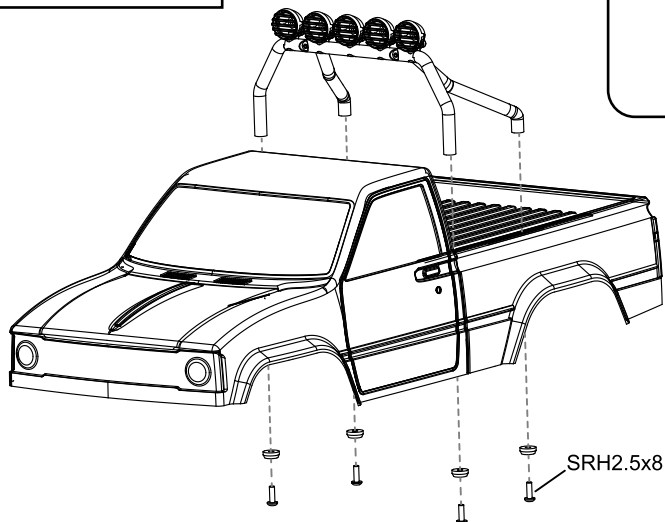
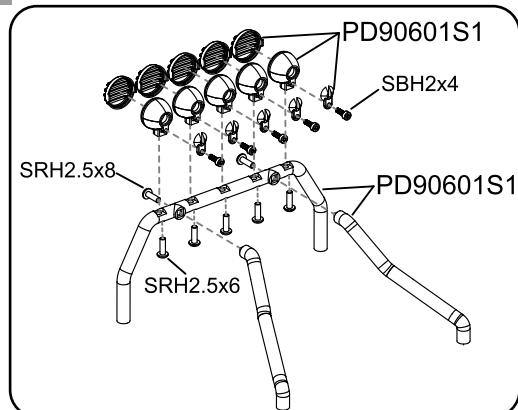

## STEP22 Body 車殼

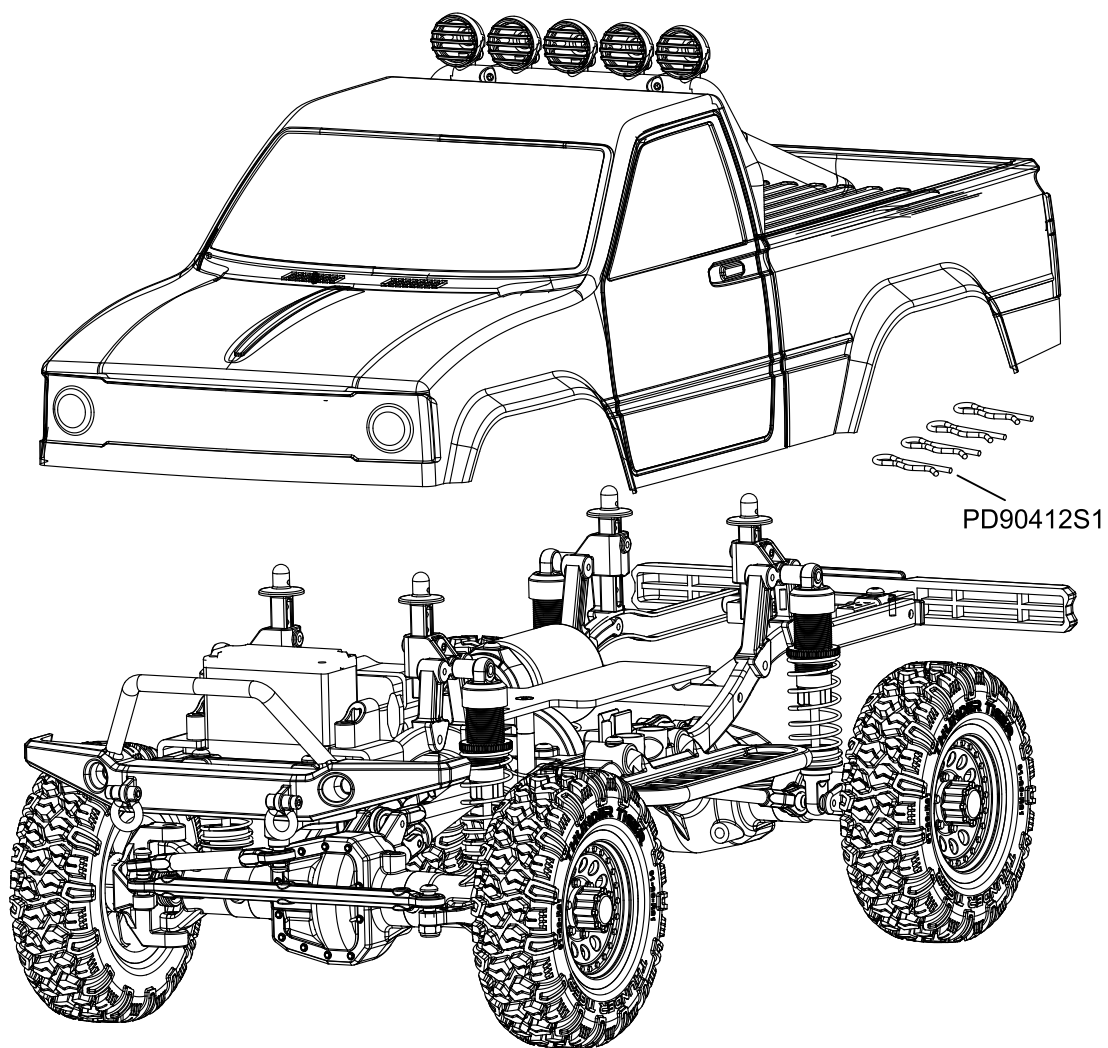



## TYPE 1 DECAL APPLICATION INSTRUCTION

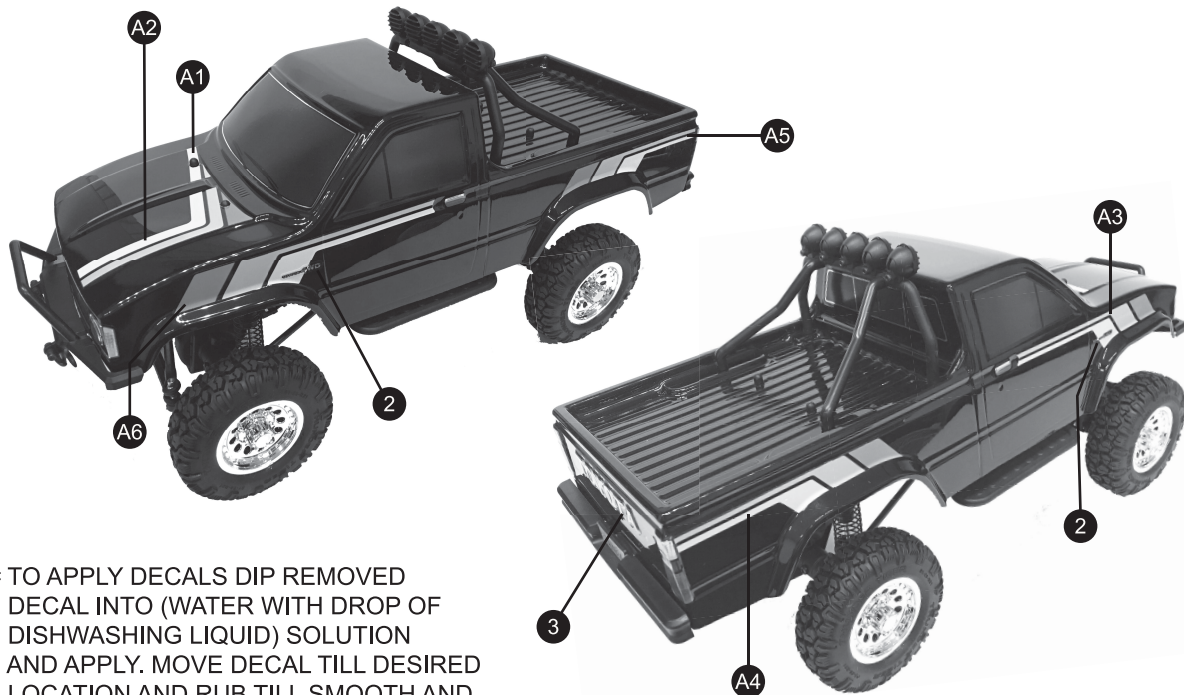

# TO APPLY DECALS DIP REMOVED DECAL INTO (WATER WITH DROP OF DISHWASHING LIQUID) SOLUTION AND APPLY. MOVE DECAL TILL DESIRED LOCATION AND RUB TILL SMOOTH AND BUBLES DISAPPEAR.

## TYPE 2 DECAL APPLICATION INSTRUCTION

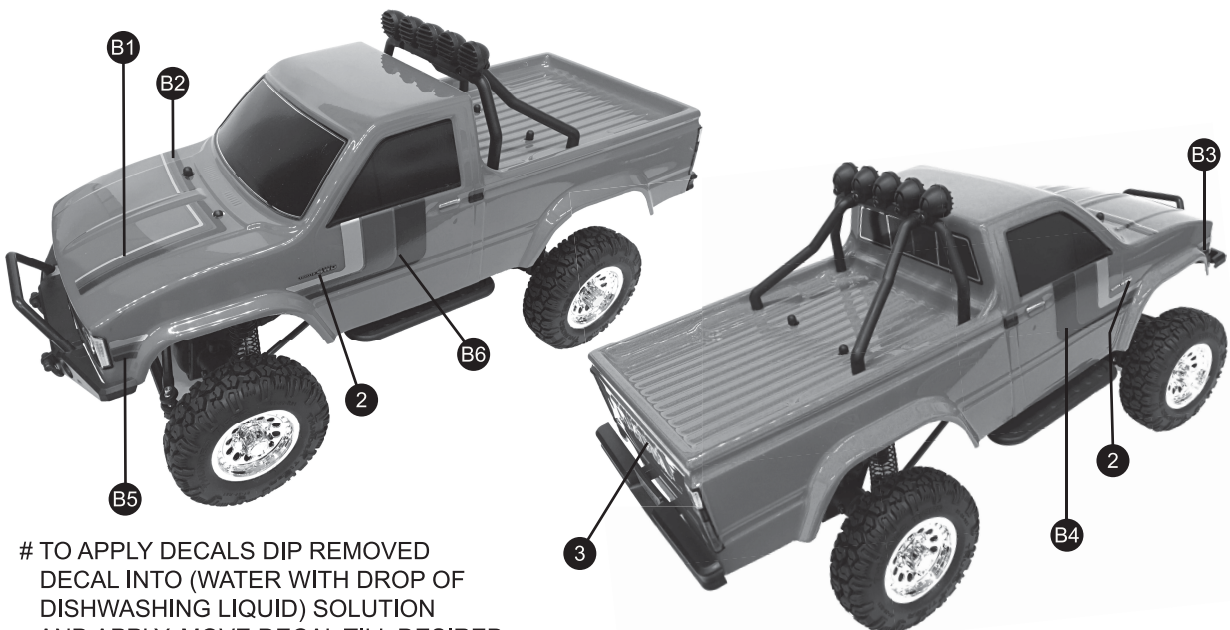

# TO APPLY DECALS DIP REMOVED DECAL INTO (WATER WITH DROP OF DISHWASHING LIQUID) SOLUTION AND APPLY. MOVE DECAL TILL DESIRED LOCATION AND RUB TILL SMOOTH AND BUBLES DISAPPEAR.

# 1/12 TOYOTA HILUX SPARE PARTS LIST 零件表

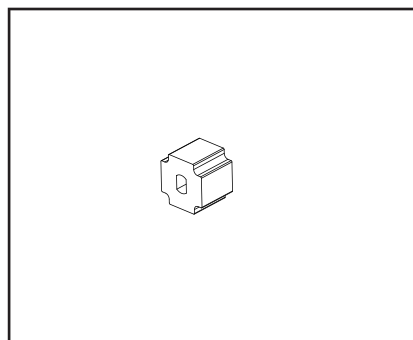

**PD90404S1** Differential Mount  
差速固定塊

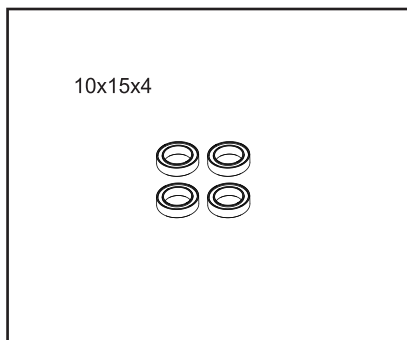

**PD90406S1** Ball Bearing 10x15x4  
培林 10x15x4

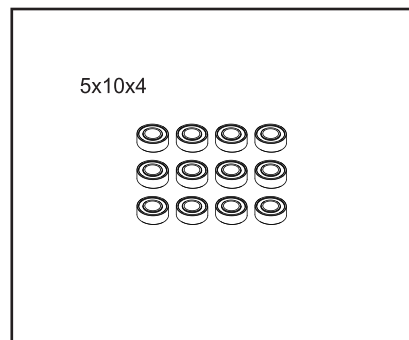

**PD90407S1** Ball Bearing 5x10x4  
培林 5x10x4

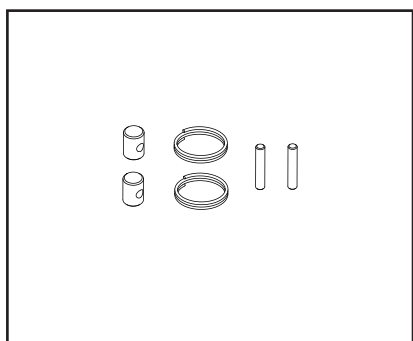

**PD90408S1**  
CVA Joint & Spring & Pin  
CVA連接座+彈簧+Pin

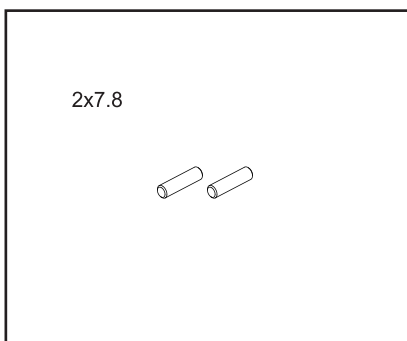

**PD90409S1**  
Spur Gear Shaft Pin 2x7.8  
中差齒固定軸 Pin 2x7.8

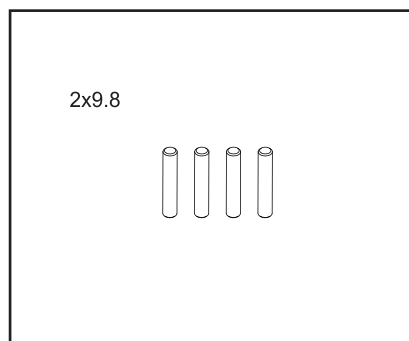

**PD90410S1**  
Wheel Nut Pin 2x9.8  
輪胎連接座 Pin 2x9.8

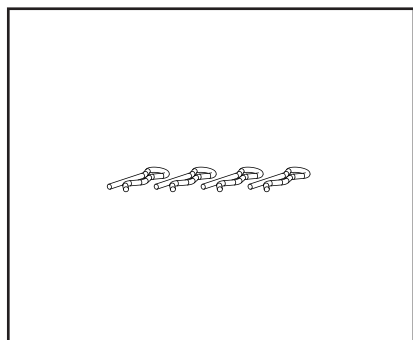

**PD90412S1** Body Clips  
車殼插銷

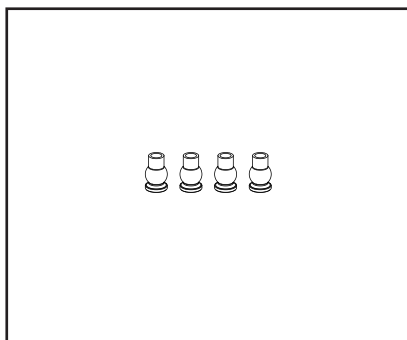

**PD90420S1** Long Ball Stud 5.0  
球頭 5.0 長

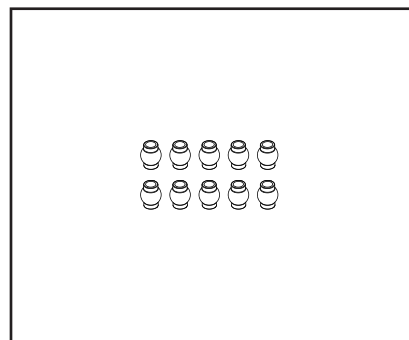

**PD90421S1** Short Ball Stud 5.0  
球頭 5.0 短

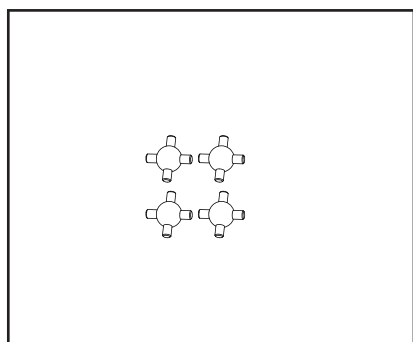

**PD90422S1** Drive Shaft Joint  
傳動軸連接座

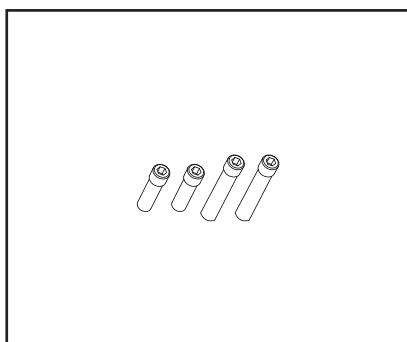

**PD90423S1**  
Long & Short Screw Pin  
螺絲插銷長+短

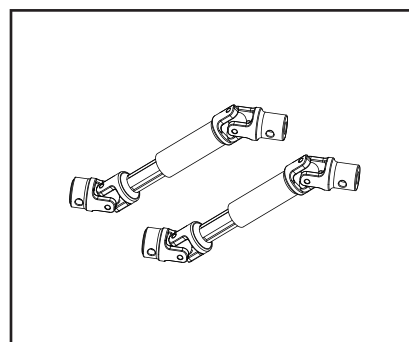

**PD90424S1** Center Drive Shaft  
中傳動軸組

# 1/12 TOYOTA HILUX SPARE PARTS LIST 零件表

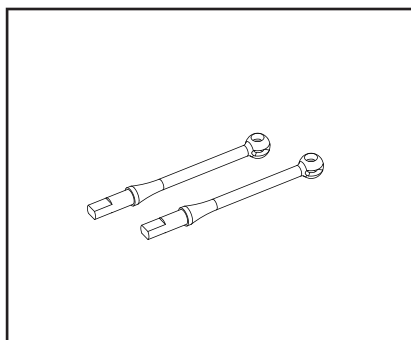

**PD90425S1** Front Drive Shaft  
前傳動軸

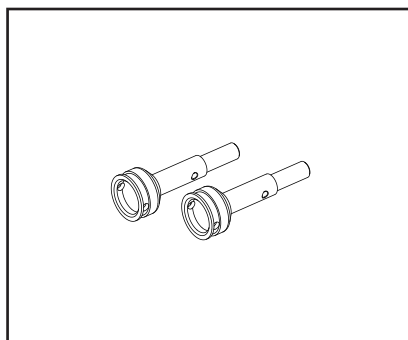

**PD90426S1** Front CVA Drive Cup  
前CVA接杯

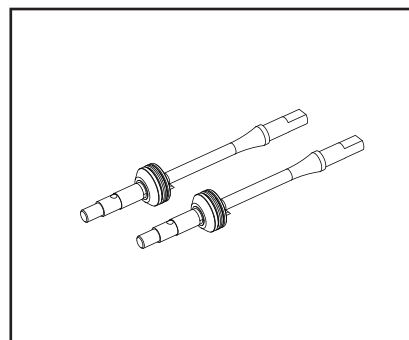

**PD90427S1** Front CVA Set  
前CVA組

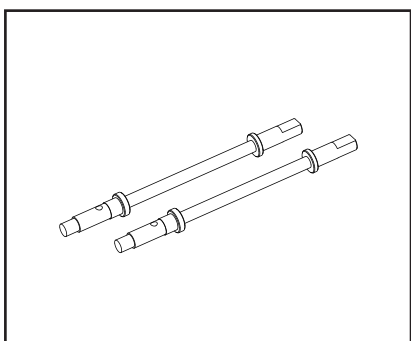

**PD90428S1** Rear Wheel Axle  
後輪軸

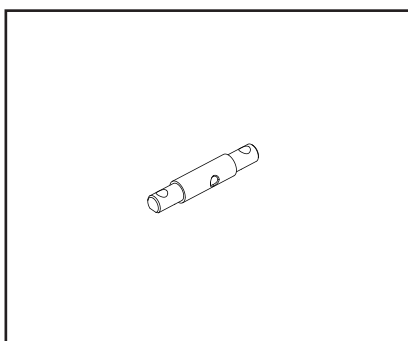

**PD90429S1** Center Shaft  
中差軸

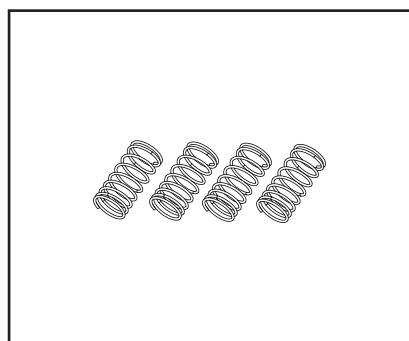

**PD90430S1** Shock Spring 0.8mm  
避震器彈簧 0.8mm

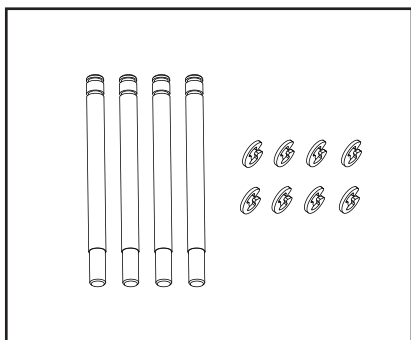

**PD90431S1** Shock Shaft & E Clips  
避震軸心+E扣

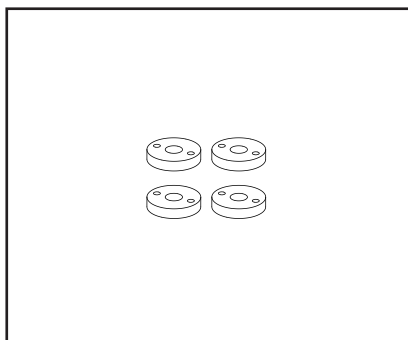

**PD90432S1** Shock Piston 8mm  
活塞 8mm

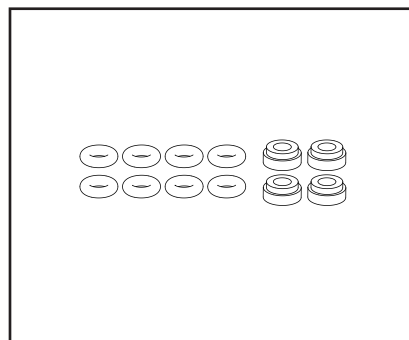

**PD90433S1**  
Shock Lower Cover Bushing & O ring  
避震器下蓋襯套+O環

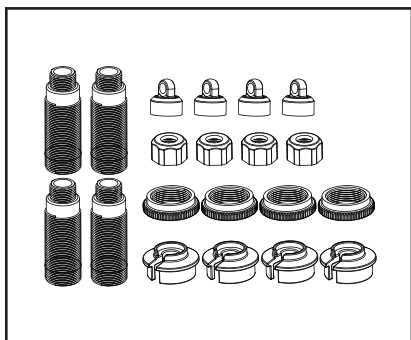

**PD90434S1** Shock Sets Plastic  
避震器配件

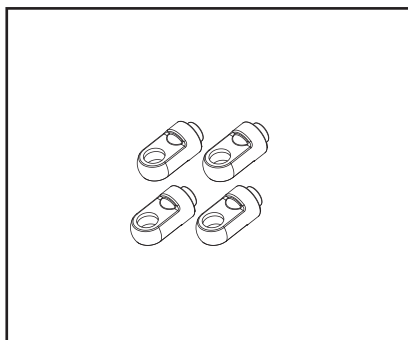

**PD90435S1** Shock Ball End  
避震器下蓋拉杆頭

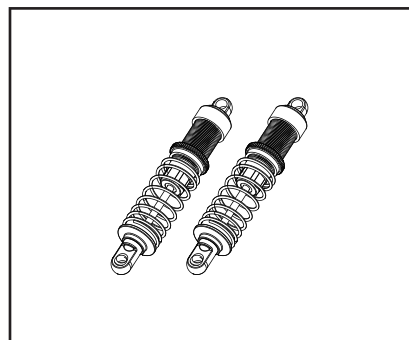

**PD90436S1** Shock Set  
避震器組

# 1/12 TOYOTA HILUX SPARE PARTS LIST 零件表

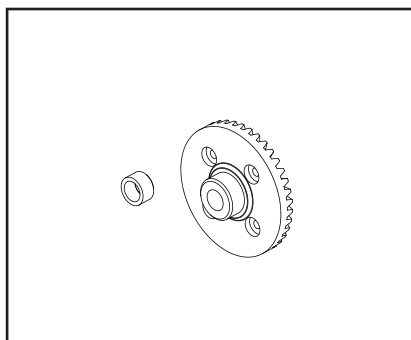

**PD90438S1** Diff Bevel Gear Plastic  
大傘齒 39T

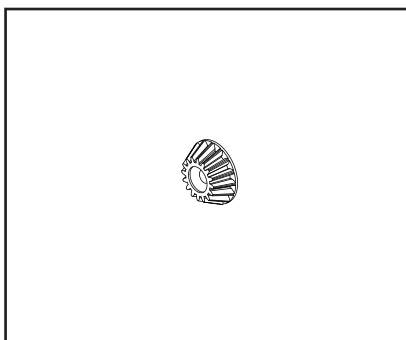

**PD90439S1** Pinion Gear 16T Metal  
小傘齒 16T

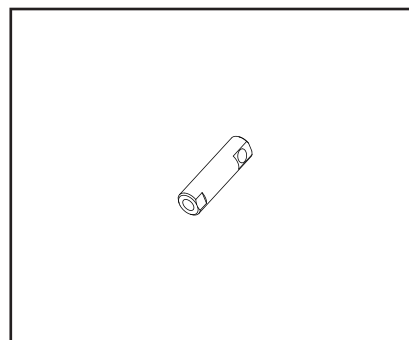

**PD90440S1** Center Drive Cup Shaft  
中前中後接杯固定軸

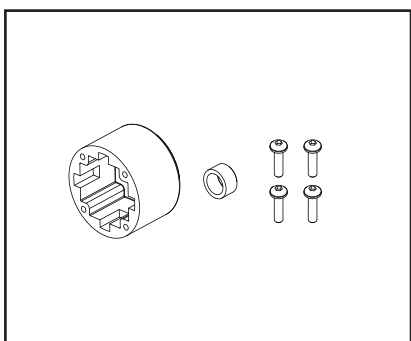

**PD90441S1** Gear Diff Case  
差速殼

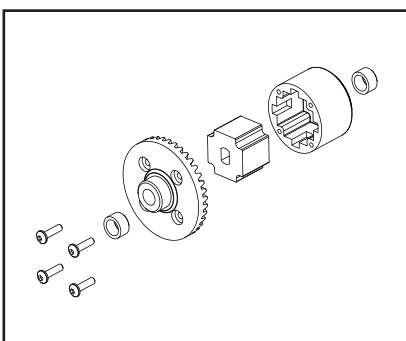

**PD90442S1** Differential Set  
差速組

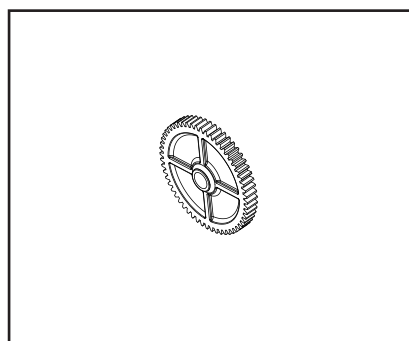

**PD90443S1** Center Spur Gear 56T Plastic  
中差齒 56T

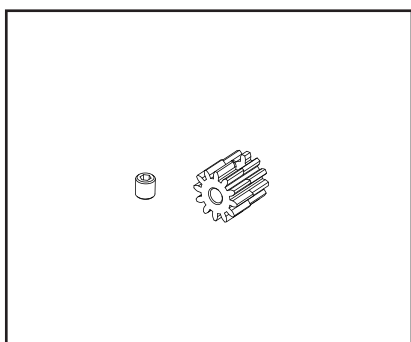

**PD90444S1**  
Pinion Gear 11T & 3x3 Screw Set  
馬達齒 11T+止合 3x3

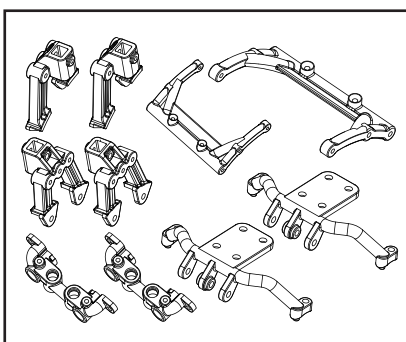

**PD90446S1**  
Bumper & Body Posts Parts  
防撞板架+車殼支柱配件

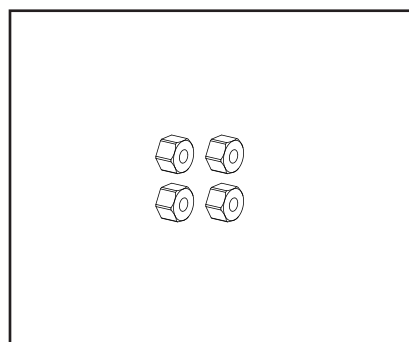

**PD90454S1** Wheel Hex  
輪胎轉接座

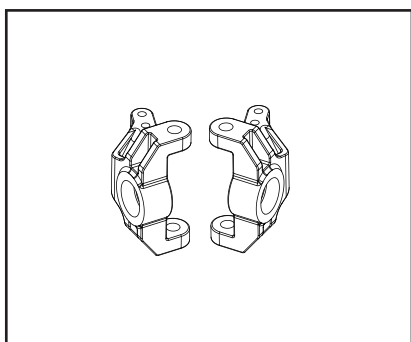

**PD90456S1** Steering Block  
前輪座

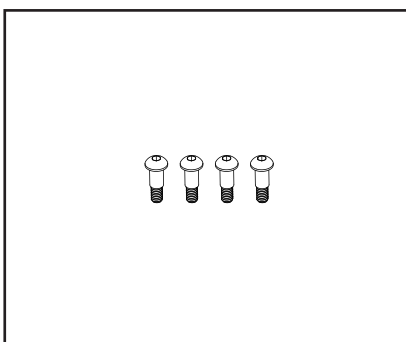

**PD90457S1** C-hub Screw 3x11.6  
C座螺絲 3x11.6 半牙

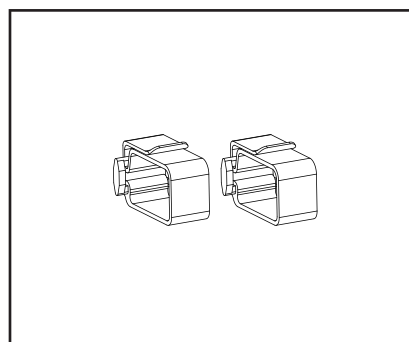

**PD90461S1** Battery Straps  
電池魔術貼

# 1/12 TOYOTA HILUX SPARE PARTS LIST 零件表

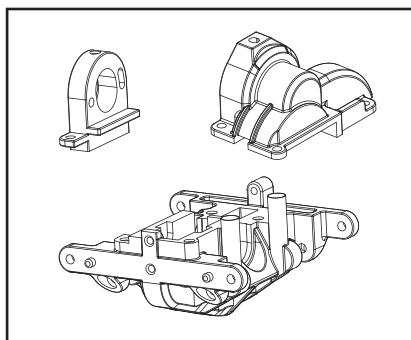

**PD90572S1** Center Diff Mount  
中差固定座

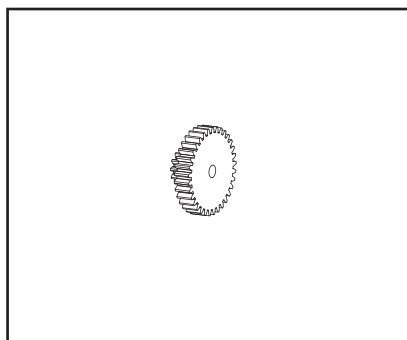

**PD90573S1**  
Center Diff Gear 33T/12T  
中差減速齒 33T/12T

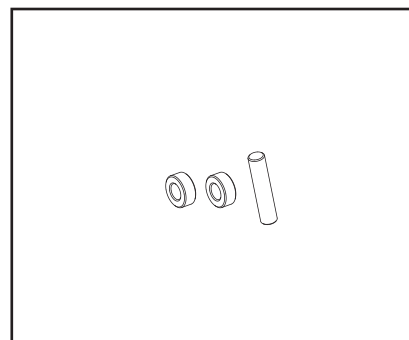

**PD90574S1**  
Bearing & Spur Gear Shaft  
培林+主齒輪軸

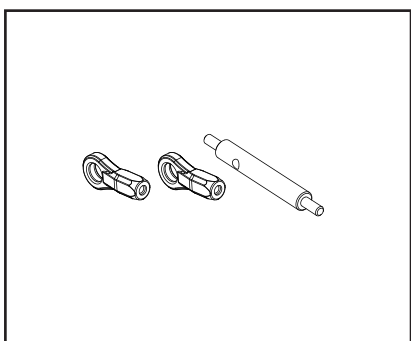

**PD90575S1** Turnbuckle  
伺服機拉杆

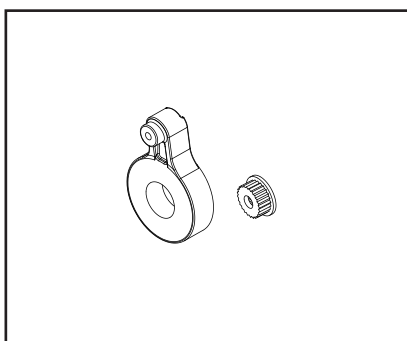

**PD90576S1** Servo Saver  
緩衝組

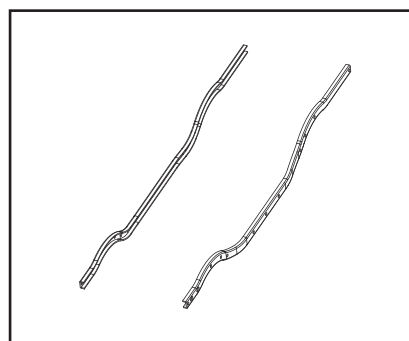

**PD90596S1** C-Channel Frame  
C型車架

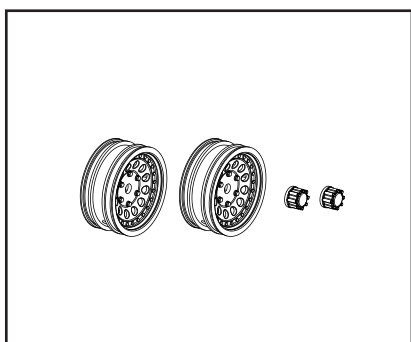

**PD90597S1** Scale Wheel Set  
像真輪框組

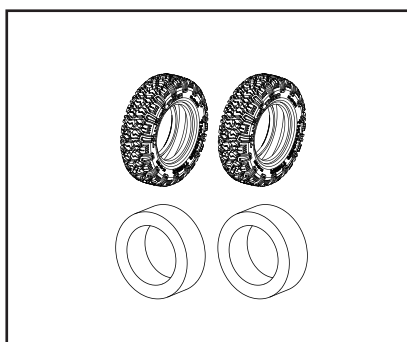

**PD90598S1** Scale Tire Set  
像真胎皮組



**PD90599S1** Scale Tire Set  
像真輪胎組(黏合)

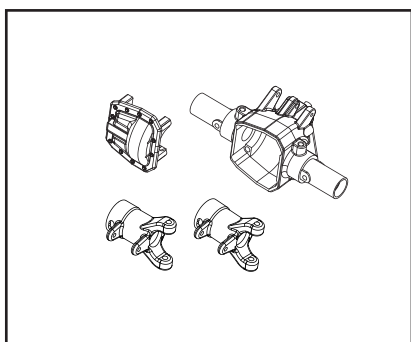

**PD90600S1** Scale Axle Set (F)  
像真齒輪箱組 (前)

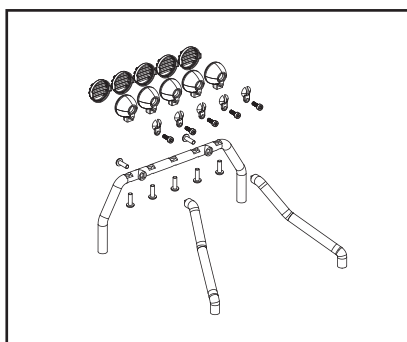

**PD90601S1** LED Light Bar Set  
車殼燈架組

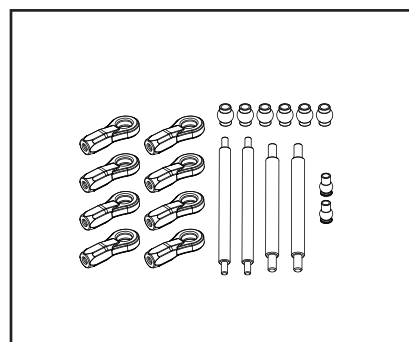

**PD90602S1**  
Adjustable Links(F)  
金屬拉杆組 (前)



# 1/12 TOYOTA HILUX SPARE PARTS LIST 零件表

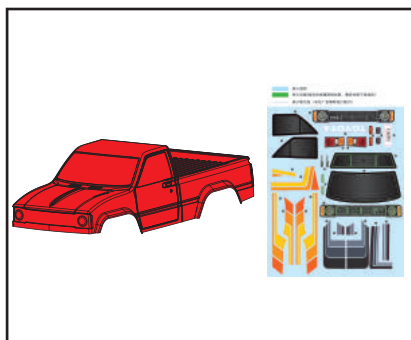

**PD90603S1**  
Pre-Painted Body RED & Sticker  
彩繪車殼 (紅) + 貼紙

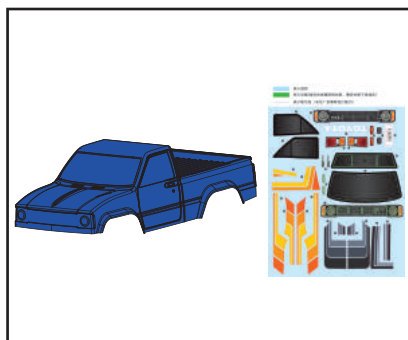

**PD90604S1**  
Pre-Painted Body BLUE & Sticker  
彩繪車殼 (藍) + 貼紙

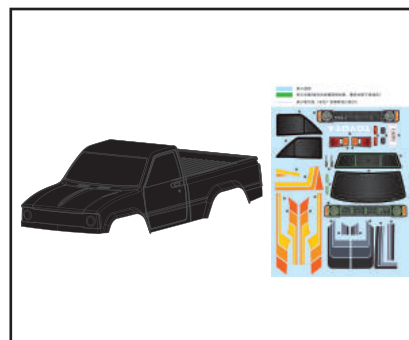

**PD90605S1**  
Pre-Painted Body BLACK & Sticker  
彩繪車殼 (黑) + 貼紙

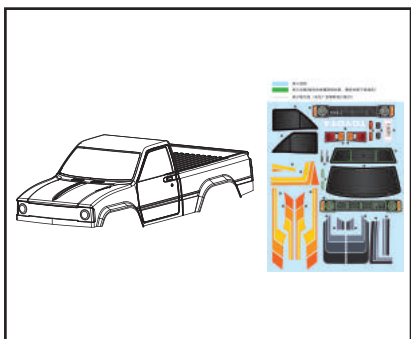

**PD90610S1**  
Option Clear PC Body & Sticker  
透明PC車殼 + 貼紙

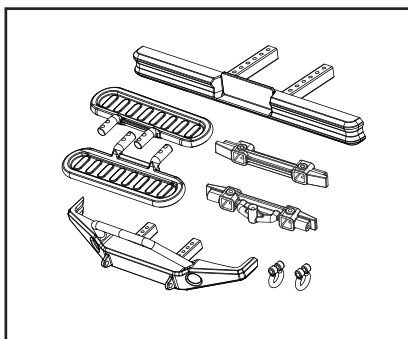

**PD90606S1**  
Side Guard & F/R Bumper Set  
側板+前後防撞板

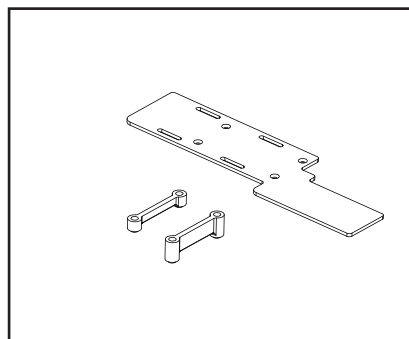

**PD90607S1**  
Battery Holder Plate Set  
電池固定板組

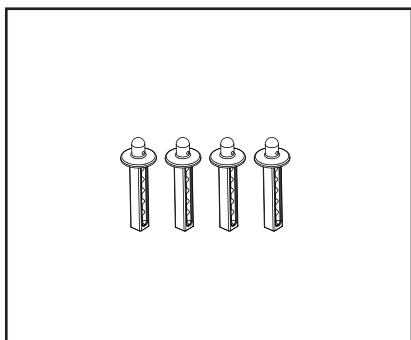

**PD90608S1** Body Post  
車殼支柱

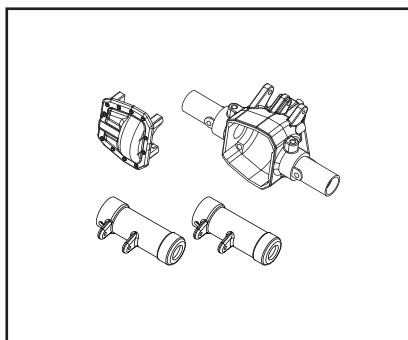

**PD90609S1** Scale Axle Set (R)  
像真齒輪箱組 (後)

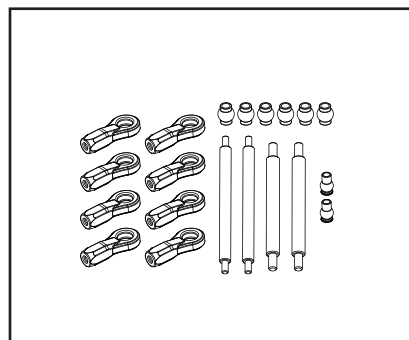

**PD90611S1**  
Adjustable Links(R)  
金屬拉杆組 (後)

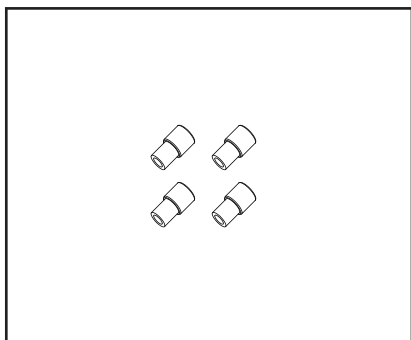

**PD90613S1** Shock Cap Bushing  
避震器上蓋襯套

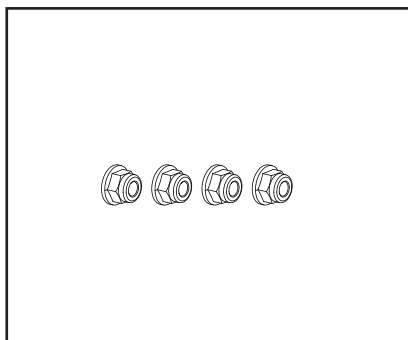

**PD90614S1** M4 Nut  
M4 防鬆螺帽



**PD90583S1** 380 Brushed Motor  
380 有刷馬達

# 1/12 TOYOTA HILUX SPARE PARTS LIST 零件表



**PD90462S1**  
Lion 850mah Battery T Plug  
850mah 鋰鐵電池 T插



**PD90463S1**  
HW 40A Brushed ESC T Plug  
Waterproof(with Drag Brake)  
40A有刷防水電調 T插(帶拖剎功能)



**PD90465S1** 3.5kg Servo  
3.5kg 伺服機



**PD90466S1**  
Balance Charger US Plug  
平衡充電器 美規



**PD90467S1**  
Balance Charger UK Plug  
平衡充電器 英規



**PD90468S1**  
Balance Charger EU Plug  
平衡充電器 歐規



**PD90616S1**  
Balance Charger AU Plug  
平衡充電器 澳規



**PD90617S1**  
USB Charger 7.4V (output 500mA)  
USB充電綫 7.4V (輸出500mA)



**PD90469S1** 2.4G Radio  
2.4G 遙控器



# Declaration of Conformity

## according R&TTE Directive 1999/5/EC

### For the following equipment:

Product : TOYOTA Hilux  
Type Designation/Trademark : 6603-F131-A1 6603-F131-A2 6603-F131-A3 6603-F131-A4 6603-F131-A5  
6603-F132-A1 6603-F132-A2 6603-F132-A3 6603-F132-A4 6603-F132-A5  
6603-F133-A1 6603-F133-A2 6603-F133-A3 6603-F133-A4 6603-F133-A5  
Manufacturer's Name : Thunder Tiger Corp.  
Manufacturer's Address : NO.7,6th RD,Industry Park,Taichung 40755,Taiwan

- Council Directive 1995/5/EC R&TTE on radio equipment and telecommunications terminal equipment and the mutual recognition of their conformity

### For the evaluation of the compliance with this Directives, the following standards were applied :

EN 55022: 2010  
EN 55024: 2010+A1: 2015  
EN 61000-3-2: 2014  
EN 61000-3-3: 2013  
EN 301 489-1 V.2.1.1:2017-02 EMC  
EN 301 489-17 V.3.1.1:2017-02 EMC  
EN 300 328 V.2.1.1:2016-11 RF  
EN 62311:2008 Health  
EN 60950-1:2006+A11:2009+A1:2010+A12:2011+A2:2013  
EN 61000-6-3:2007+A1:2011+AC:2012  
EN 61000-6-1:2007  
FCC PART 15B  
CE/2015/A2183  
BS EN 61558-2-16:2009  
BS EN 6155-2-7:2007  
BS EN 61558-1/A1:2009  
EN 61558-2-16:2009  
EN 61558-2-7:2007  
EN 61558-1/A1:2009  
ZEX 01.4-08  
UL 60950-1 and CSA C22.2 NO.60950-1-07  
SVHC NO.CANEC 1508590001  
2006/66/EC

### Responsible for making this declaration is the :

Manufacturer ☒ Authorized representative established within the EU ☐

### EC Distribution

Company Name : Thunder Tiger Corp.  
Company Address : NO.7,6th Road,Industry Park,Taichung 40755,Taiwan

### Person responsible for making this declaration :

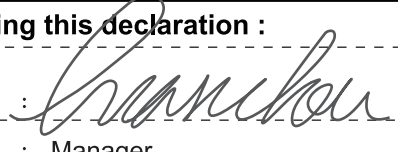
Name, Surname :   
Position/Title : Manager  
Date : May 2017

